



**1100 W. WILLIS WAY, GRAND CHUTE  
LOT 41, BUTTERFLY FIELDS  
\$176,900**

Municipality: Grand Chute  
County: Outagamie  
Tax ID: 102-529700  
School District: Appleton Area  
Zoning: Residential  
Lot Size: 80' x 140'  
Style: Ranch  
Exterior: Brick, Vinyl



Home Size: 1700 sq. ft. finished  
Garage: 2 Stall, Attached  
Basement: Full  
Type of Heat: Gas, Forced Air  
Central Air: No  
Fireplace: Yes  
Municipal Water: Yes  
Sanitary Sewer: Yes  
Appliances Incl.: Disposal

# Bedrooms: 3  
# Bathrooms: 2 full  
Great Room: 22' x 15'  
Kitchen: 11' x 14'  
Dining Room: 12' x 14'  
Bedroom 1: 15' x 14'  
Bedroom 2: 12' x 12'  
Bedroom 3: 12' x 12'

Directions: Hwy 41 S. toward Appleton, take Richmond St. Exit. Take a right on Richmond. To Evergreen Drive and go left. To Orion Lane and go right. To W. Willis Way and go right. Home is on your left.

Remarks: 1700 sq. ft. 3 bed/2 bath, 1<sup>st</sup> floor laundry, split bedroom design ranch. Vaulted and Cathedral ceilings. Tile, carpet & hardwood floors. Custom maple cabinets, 3 1/4 maple trim. Large windows in LL & rough in for a 3<sup>rd</sup> bath. Professionally designed with a ton of detail. New subdivision, Appleton schools, Grand Chute taxes.

*The accuracy of the information contained in this data sheet is not warranted and is subject to change without notice.*

Revised December 15, 2011

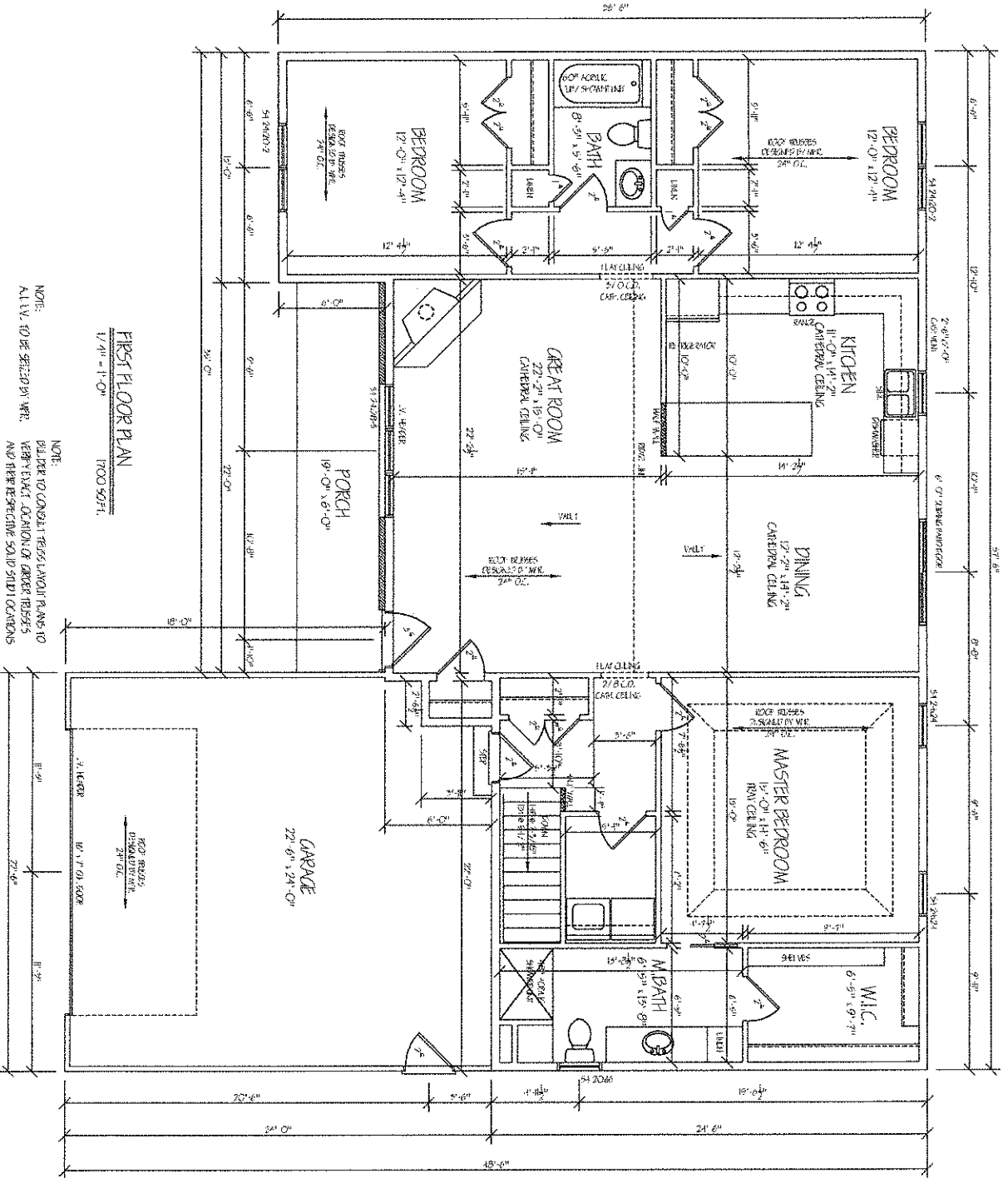

**FIRST FLOOR PLAN**  
 1/4" = 1'-0"  
 7000 SQ.FT.

NOTE:  
 BELIEVER TO CONSULT THESE LAYOUT PLANS TO  
 VERIFY EXACT LOCATION OF ORDER DEVICES  
 AND THEIR RESPECTIVE SOLID SHIP CONDITIONS

ALTHOUGH EVERY EFFORT HAS BEEN  
 MADE TO PREPARE THESE PLANS  
 AND CHECKING THEM FOR ACCURACY,  
 THE CONTRACTOR/BUILDER MUST  
 CHECK ALL STRUCTURAL DETAILS  
 AND BE RESPONSIBLE FOR THE SAME

THESE ARCHITECTURAL PLANS ARE  
 THE PROPERTY OF GREEN BAY  
 AND WILL BE RETURNED TO THE  
 ARCHITECT UPON COMPLETION OF  
 THE PROJECT. NO REPRODUCTION  
 OR TRANSMISSION OF ANY KIND  
 IS PERMITTED WITHOUT THE  
 WRITTEN PERMISSION OF THE  
 ARCHITECT. ANY VIOLATION OF  
 THESE TERMS SHALL BE CONSIDERED  
 A BREACH OF CONTRACT AND  
 SUBJECT TO LEGAL ACTION.

**COACH HOMES**  
**CHELSEA 3-1700**  
 GREEN BAY, WI

**A-2**

7/28/11